

INSTALLATION INSTRUCTIONS

DESCRIPTION: Overfender Kit
 PART NUMBER: 2UD-F15E0-V0
 MODEL: Grizzly 700 (2016+)



⚠ WARNING

Please read and understand these instructions completely before installation to avoid possible injury to yourself, or damage to the accessory or vehicle.

WARRANTY INFORMATION:

Genuine Yamaha accessories are covered by a one-year limited warranty against defects in material or workmanship. Labor for replacement of defective components is not covered. See your Yamaha dealer for a copy of the warranty statement.

DEALER OR INSTALLER:

These instructions contain important information for future reference and *must* be given to the customer.

PARTS LIST:

No.	Part Number	Description	Qty
*	2UD-F15E0-V0	Overfender Kit	--
①	*	Left Front Overfender	1
②	*	Left Rear Overfender	1
③	*	Right Rear Overfender	1
④	*	Right Front Overfender	1
⑤	*	Spacer	18
⑥	*	Button Head Hex Bolt	20
⑦	*	Washer	32
⑧	*	Button Head Hex Bolt - Short	12
⑨	*	Fender Washer	32
⑩	*	Nylock Nut	32

* Part supplied with kit only and not available separately.

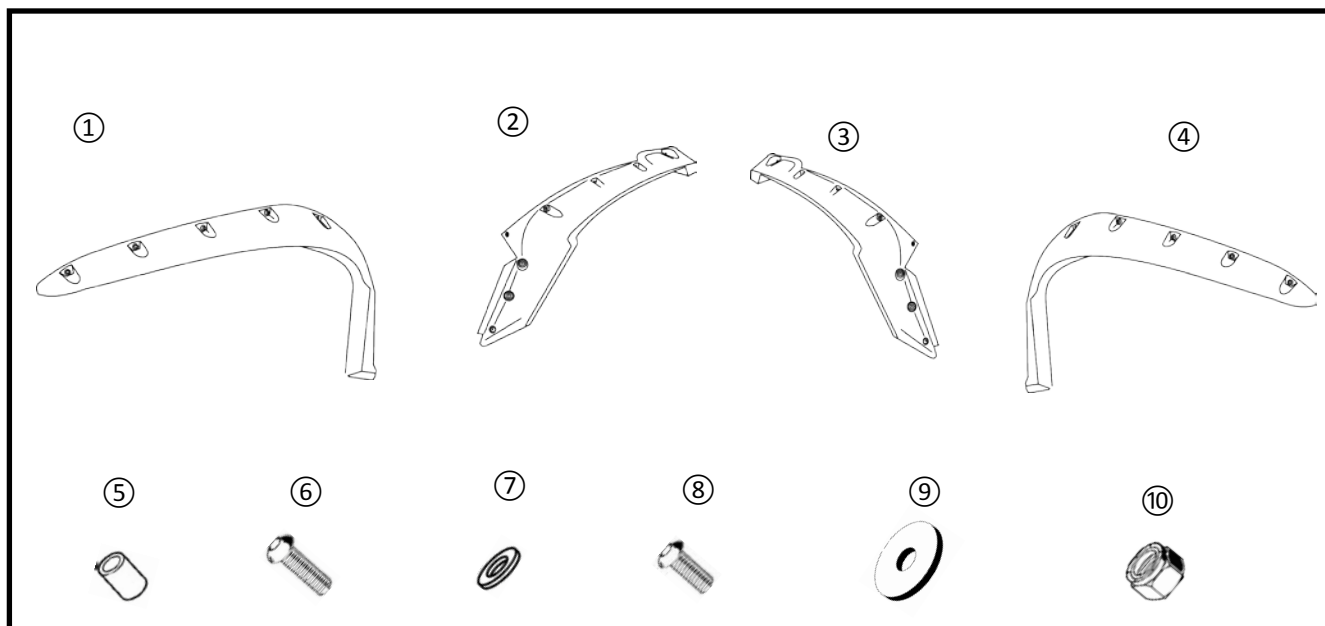

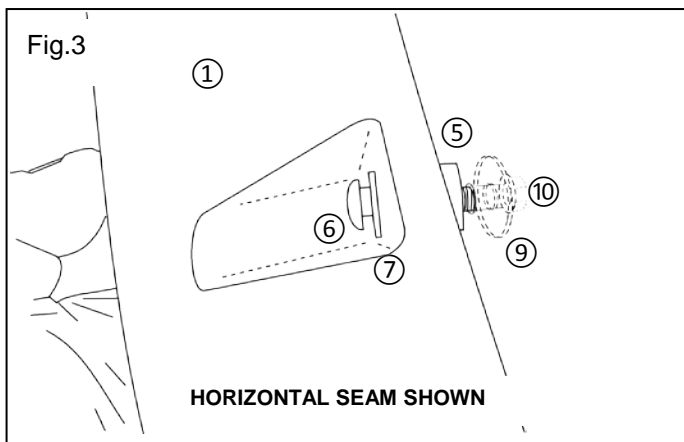
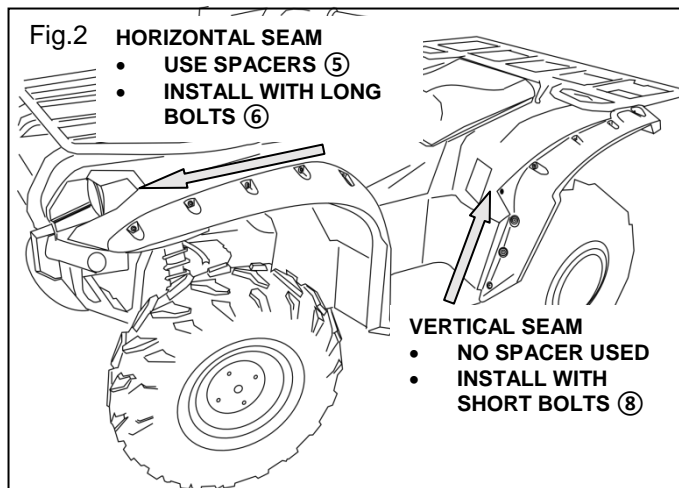
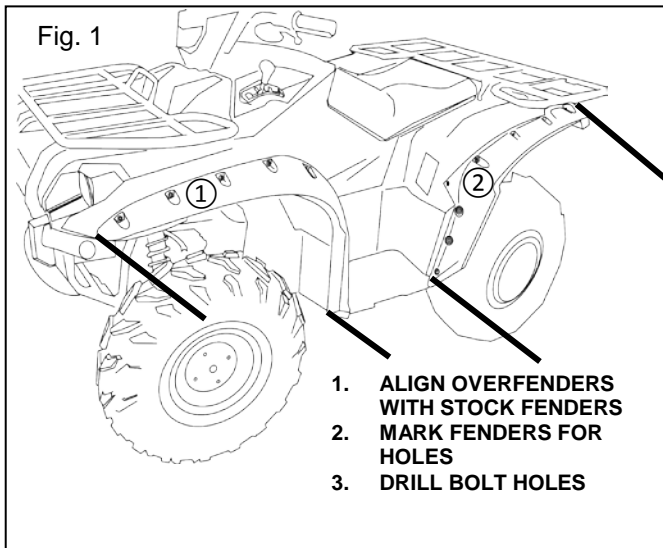

PREPARATION:

1. Place vehicle on a secure and level surface.
2. Set the parking brake.
3. Clean all mounting surfaces before installation.

INSTALLATION:

1. Start on the left front.
2. Position the left front overfender ① to align front and rear with the stock fender.
3. Use the bolt holes on the overfender to mark bolt hole locations on the stock fender.

TIP: Hold the overfender in place with blue painter's tape or have it held by an assistant.

4. Use a 1/4" drill bit to drill through the stock fender in the eight overfender mount locations (Fig. 1).

TIP: Drill one hole first, install a bolt assembly (steps 5 and 6), and then move on to the next. Align and adjust the overfender as you go.

5. Start on the horizontal seam. Place a washer ⑦ on a longer bolt ⑥ and insert the bolt through the overfender. Place a spacer ⑤ on the bolt between the overfender and the stock fender (Fig 2 and Fig 3).
6. From the backside of the stock fender, place a fender washer ⑨ and nylock nut ⑩ on the bolt loosely. You will need space and flexibility to install all the spacers (Fig. 3).
7. Install the shorter bolts ⑧ with washers ⑦ on the vertical seam. These bolts do not need spacers. Install a fender washer ⑨ and nylock nut ⑩ as described in step 6.
8. Repeat steps 2 through 7 to install the other three overfenders.
9. Tighten bolts hand tight so that the parts are snug. **NOTICE: The plastic could be damaged by over tightening.**

MAINTENANCE:

Check and adjust as necessary.

CARE AND CLEANING:

Wash with a mild soap and water solution using a soft cloth. Using Yamacoat™ spray (ACC-YAMAC-OA-TC), available from your Yamaha dealer, will help keep the overfenders and other plastics easy to clean and looking new.

CUSTOMER SERVICE:

For further information see your Yamaha dealer.

ESTIMATED TIME TO INSTALL: 1.0 HR